

2023 JLPT
Test Site Information – Boston, MA

Test Date: **Sunday, December 3, 2023**

Test Location: **Showa Boston Institute**

420 Pond Street, Boston, MA 02130

Tel: (617) 522-0080

URL: <https://www.showaboston.edu/>

Reporting Time and Test Schedule:

- Please arrive at the test site during the scheduled reporting time. Your check in location is the 420 Pond Street building. If you are driving, park in the designated areas on the map (attached). Parking fee is \$5.00 per car (cash only). Upon arriving at the test site, report to your assigned classroom. You must present your **admission voucher** (printed out) and proper **photo identification** to a proctor in order to be allowed into the classroom.
- Since the test takes place during winter when severe weather could affect roads and public transportation, please make sure you allow for extra time to reach the test site as well as to return to your destination.

Test Schedule

| Level | Report Time ID Check | Test Instruction | Language Knowledge & Reading | Break | Test Instruction | Listening |
|-----------|-------------------------|-----------------------|---------------------------------|-----------------------|----------------------|-----------------------|
| N1 | 12:30- 1:00 (30 min) | 1:00-1:10 (10 min) | 1:10-3:00 (110 min) | 3:00-3:20 (20 min) | 3:20-3:25 (5 min) | 3:25-4:20 (55 min) |
| N2 | 12:30- 1:00 (30 min) | 1:00-1:10 (10 min) | 1:10-2:55 (105 min) | 2:55-3:15 (20 min) | 3:15-3:20 (5 min) | 3:20-4:10 (50 min) |

| Level | Report Time ID Check | Instruction | Vocabulary | Break | Instruction | Grammar & Reading | Break | Instruction | Listening |
|-----------|-------------------------|-----------------------|-----------------------|-----------------------|----------------------|-----------------------|-----------------------|----------------------|-----------------------|
| N3 | 12:30-1:00 (30 min) | 1:00-1:10 (10 min) | 1:10-1:40 (30 min) | 1:40-1:55 (15 min) | 1:55-2:00 (5 min) | 2:00-3:10 (70 min) | 3:10-3:25 (15 min) | 3:25-3:30 (5 min) | 3:30-4:10 (40 min) |
| N4 | 12:30-1:00 (30 min) | 1:00-1:10 (10 min) | 1:10-1:35 (25 min) | 1:35-1:50 (15 min) | 1:50-1:55 (5 min) | 1:55-2:50 (55 min) | 2:50-3:05 (15 min) | 3:05-3:10 (5 min) | 3:10-3:45 (35 min) |
| N5 | 12:30-1:00 (30 min) | 1:00-1:10 (10 min) | 1:10-1:30 (20 min) | 1:30-1:45 (15 min) | 1:45-1:50 (5 min) | 1:50-2:30 (40 min) | 2:30-2:45 (15 min) | 2:45-2:50 (5 min) | 2:50-3:20 (30 min) |

Note1: There will be a short break between sections. The schedule above is subject to change in the event of any unexpected situation at the test site.

Note2: The running time of the Listening comprehension may fluctuate by plus or minus 2 to 3 minutes depending on the year. Therefore, the end time of the final subject may vary slightly

Special Accommodations:

Test schedule for test taker(s) with special arrangements is (are) as follows:

| Level | Report Time ID Check | Instruction | Vocabulary | Break | Instruction | Grammar & Reading | Break | Instruction | Listening |
|---------------------|-------------------------|-------------------------|---------------------|-----------------------|----------------------|--------------------|----------------------|----------------------|--------------------|
| N5 50006 | 12:30-12:40 (10 min) | 12:40-12:50 (10 min) | 12:50-1:20 TBA30 | 1:20-1:35 (15 min) | 1:35-1:40 (5 min) | 1:40-2:40 TBA60 | 2:40-2:55 (15min) | 2:55-3:00 (5 min) | 3:00-3:45 TBA45 |

Note: The above schedules are approximate. Subject to change depending on the headquarters' decision on the application for Special Accommodation in November.

Room Assignment:

- Your room assignment is based on the last 5 digits of your registration number, which is printed on your admission voucher.
- Room assignments are subject to change on the test day. In case there is a room change, a notice will be posted.

| Test Level | Registration Numbers | Location (Classroom #) |
|-----------------------|--------------------------|-------------------------------|
| N1 | 10001-10015 | Building 418 Classroom 310 |
| N1 | 10016-10030 | Building 418 Classroom 309 |
| N1 | 10031-10045 | Building 418 Classroom 308 |
| N1 | 10046-10061 | Building 418 Classroom 304 |
| N2 | 20001-20012 | Building 420 C Classroom C101 |
| N2 | 20013-20028 | Building 420 C Classroom C102 |
| N2 | 20029-20045 | Building 420 C Classroom C103 |
| N2 | 20046-20057 | Building 420 C Classroom C104 |
| N3 | 30001-30035 | Building 420 Provost Hall |
| N3 | 30036-30051 | Building 420 Study 6 |
| N4 | 40001-40018 | Building 420 Study 8 |
| N4 | 40019-40037 | Building 420 Study 9 |
| N5 | 50001-50005, 50007-50018 | Building 418 Classroom 305 |
| N5 (SA) | 50006 | Building 420 Study 2 |
| N5 | 50019-50036 | Building 418 Classroom 306 |
| Administration Office | | Building 420 Rainbow Hall |

General Testing Guidelines:

- Dress so that you can adapt to any room temperature.
- Guests who accompany you to the test center are not allowed in the classroom.
- You are not allowed to leave the test room until a proctor dismisses you. If you get sick during the test and must leave the room, you must notify the proctor so that the proctor can accompany you out of the room.

What to Bring to the Test Site: You **MUST** bring the following items to the test site.

1. Your **admission voucher**.
2. A **valid form of photo ID**. Copies are not accepted.
 - Acceptable forms of official identification include driver's license, passport, or student ID. Social security cards, credit or ATM cards, and retail credit cards are not acceptable.
 - The name on your voucher must match the name on the official ID that you bring to the test center.
 - It is your responsibility to ensure that your official ID is valid and available on the day of the test.
 - ID checks are strictly enforced. If you arrive at the test center without a valid ID, you will not be permitted to take the test.
3. Several sharpened No. 2 or HB **pencils** and an **eraser** for multiple-choice answer sheets.
Pencils and erasers will not be supplied at the test center.
4. An analog watch is recommended.
Do NOT bring a watch that beeps. **You cannot use your cell phones as a timepiece.**

Prohibited Materials: Do Not Bring the Following Items to the Test Site:

1. Electronic equipment, including **cell phones** of any kind; **personal computing devices** (laptops, notebooks, **Bluetooth devices** such as wireless earbuds/headphones, or tablets); **cameras**; separate timers of any kind; audio players/recorders or headphones; wearable technology; **digital watches**, including smartwatches; or any other prohibited devices that can be used to record, transmit, or receive information.
 - All cell phones and other devices described above must be completely turned off and stored in your bag under your seat during the test. If your device makes any noise for whatever reason, including incoming calls, vibrate mode, accidents, etc., we will void your test score and you will not receive a score for the test.
2. Handwritten or printed materials.
 - cheat sheets written on paper, Japanese characters on skin, clothing and personal belongings.
3. **Food or drinks**, except water in a clear bottle with **no label** and **with a secure lid**.
The water bottle must be stored in your bag under your seat, not on your desk, during the test.

Note: If you are traveling from a distance and have any prohibited items or a travel bag with you, you must leave your belongings with a proctor at your designated classroom during the test. Your personal bag should be kept under your seat and should not block any walkways.

Directions to the Test Location:

Buses from Reservoir Station (the nearest station on the D branch of the MBT's Green Line)

- The Subway Schedule is available at: <https://www.mbtta.com/>
- Showa Boston will provide shuttle-bus service from the nearest subway station to the campus for people who use public transportations.
- All shuttles arrive and depart from the lobby (420 Pond Street Building)

Extra shuttle buses will operate at the following times on Test Day: from Reservoir Station to Showa at 10:50 AM and 11:50 AM; from Showa to Reservoir Station at 5:00 PM.

Shuttle bus schedule:

| Depart Showa | Depart Reservoir |
|--------------|------------------|
| 9:40 AM | 9:50 AM |
| 10:40 AM | 10:50 AM |
| 11:40 AM | 11:50 AM |
| 12:40 AM | 12:50 AM |
| 1:40 AM | 1:50 AM |
| 2:40 PM | 2:50 PM |
| 4:40 PM | 4:50 PM |
| 5:40 PM | 5:50 PM |
| 6:40 PM | 6:50 PM |
| 7:40 PM | 7:50 PM |
| 8:40 PM | 8:50 PM |
| 9:40 PM | 9:50 PM |

Driving Directions: Available on <https://www.showaboston.edu/>

Parking Information:

- Parking is available; please follow the sign when you get to the Showa Boston gate.
- Showa Boston's 40-acre campus can accommodate 300 cars.
- If you are driving, park in the designated areas on the map (attached).
- **Parking fee is \$5.00 per car (cash only).**



Contact:

Please direct all questions and inquiries to:
American Association of Teachers of Japanese (AATJ)
Tel: (303) 492-5487 E-mail: jlpt@aatj.org

SHOWA BOSTON BUILDING 420 MAP

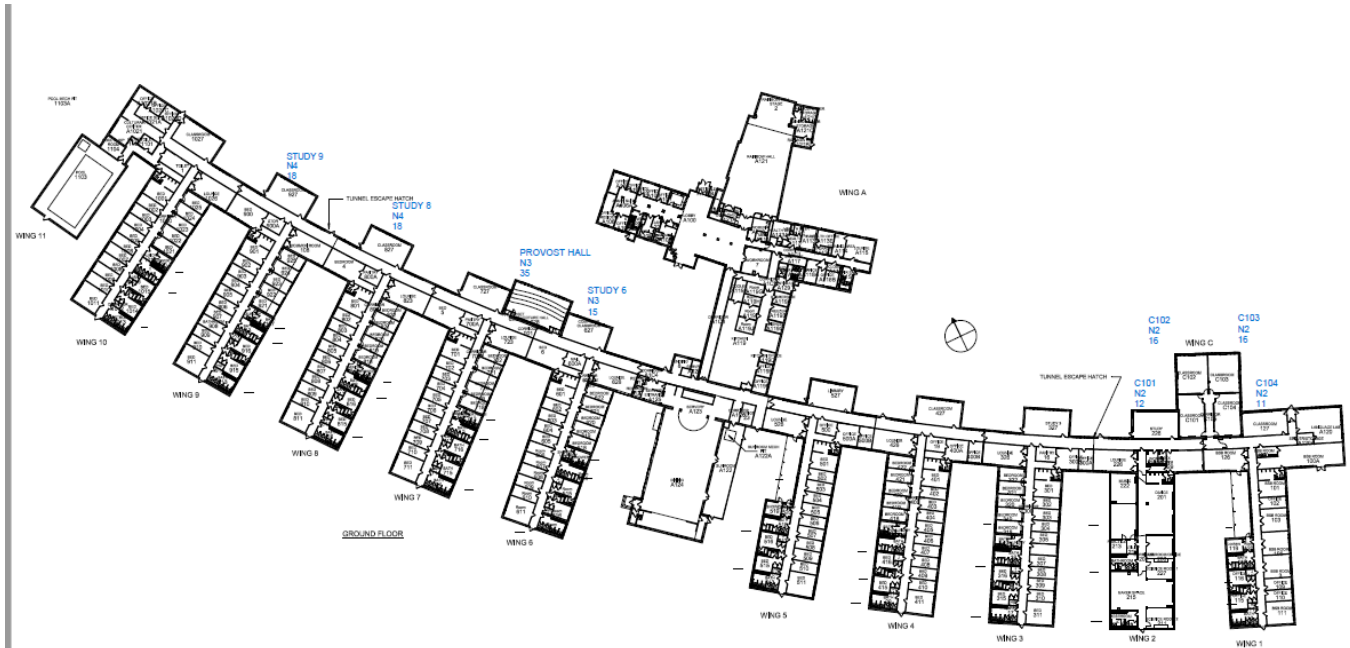

SHOWA BOSTON BUILDING 418 MAP

